

# Standard Torsion Springs for Sectional Doors

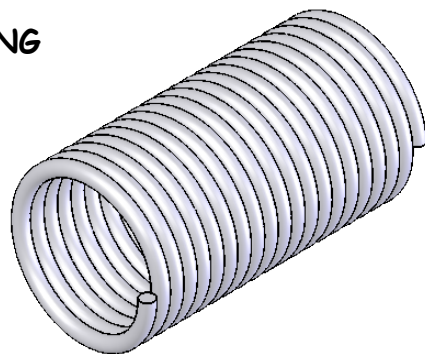

**mollificio Pavano s.p.a**  
 Via Overijse, 3 23900 LECCO (ITALY)  
 Tel. 0341 - 42.02.74 / Fax 0341-42.22.57  
 www.mollificio-pavano.it

**RIGHT COILING  
(DX)**



**LEFT COILING  
(SX)**

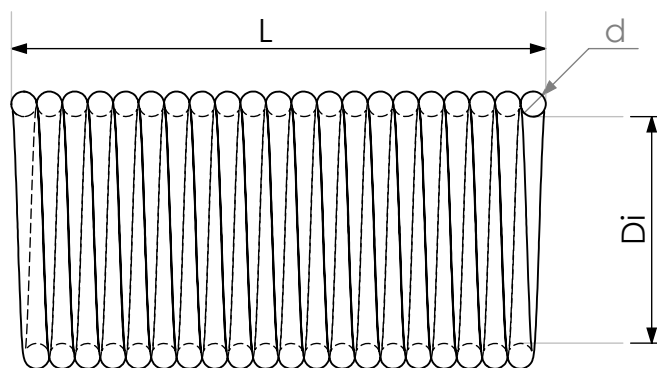
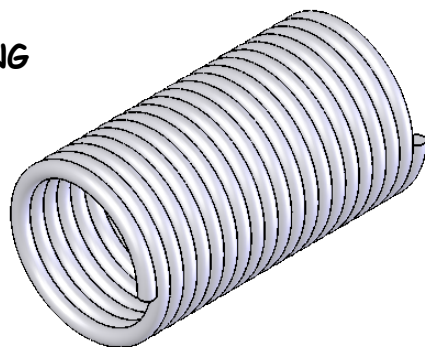

Int. Diameter (Di)	Wire Diameter (d)	Material	Maximum Length (L)
50,8 (+0/-1,5)	From 4,0 to 12,50	Phosfatated SH EN 10270:1 (C DIN 17223)	4000 max
	From 4,0 to 10,50	Galvanized SH EN 10270:1 (C DIN 17223)	
66,7 (+0/-1,5)	From 4,0 to 12,50	Phosfatated SH EN 10270:1 (C DIN 17223)	4000 max
	From 4,0 to 10,50	Galvanized SH EN 10270:1 (C DIN 17223)	
95,25 (±1,5)	From 4,0 to 12,50	Phosfatated SH EN 10270:1 (C DIN 17223)	4000 max
	From 4,0 to 10,50	Galvanized SH EN 10270:1 (C DIN 17223)	
133,3 (±2,5)	From 4,0 to 12,50	Phosfatated SH EN 10270:1 (C DIN 17223)	4000 max
	From 4,0 to 10,50	Galvanized SH EN 10270:1 (C DIN 17223)	
152,5 (±2,5)	From 4,0 to 12,50	Phosfatated SH EN 10270:1 (C DIN 17223)	4000 max
	From 4,0 to 10,50	Galvanized SH EN 10270:1 (C DIN 17223)	